

# Campus Library

## 3<sup>rd</sup> Level

### Library LB1 & LB2 - 3rd Level

- Library Offices      LB1-310A to LB1-310H
- Materials Processing      LB1-311A to LB1-311B
- Stacks, Periodicals, Newspaper, PSC, Childrens Literature, Curriculum Materials, Practicums, Folios
- Group Study Rooms / Study Areas
- ESL Reading Area

### Library LBA - 3rd Level

- Library Offices      LBA-302, -306, -308, -309
- Group Study Rooms/Reading Room      LBA 305, -303, -304
- Teaching and Learning Academy / AmeriCorps      LBA 307

- Elevator    Restroom    Stairs
- Fire Extinguisher    Alarmed Door

### LB2 Library Building 2

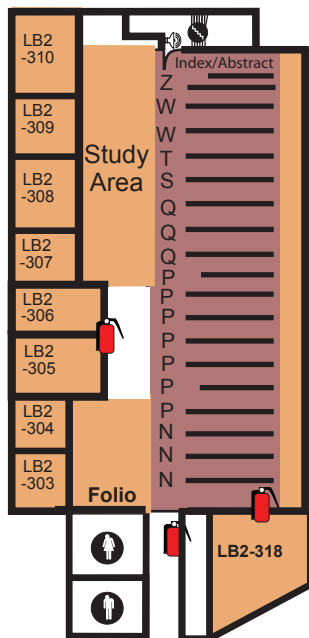

### LBA Library Building Annex

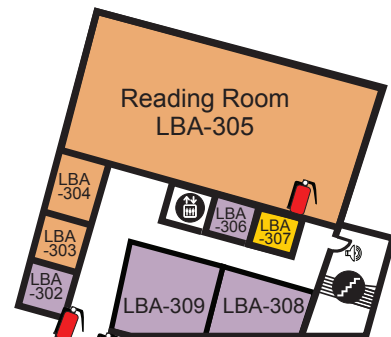

### LB1 Library Building 1

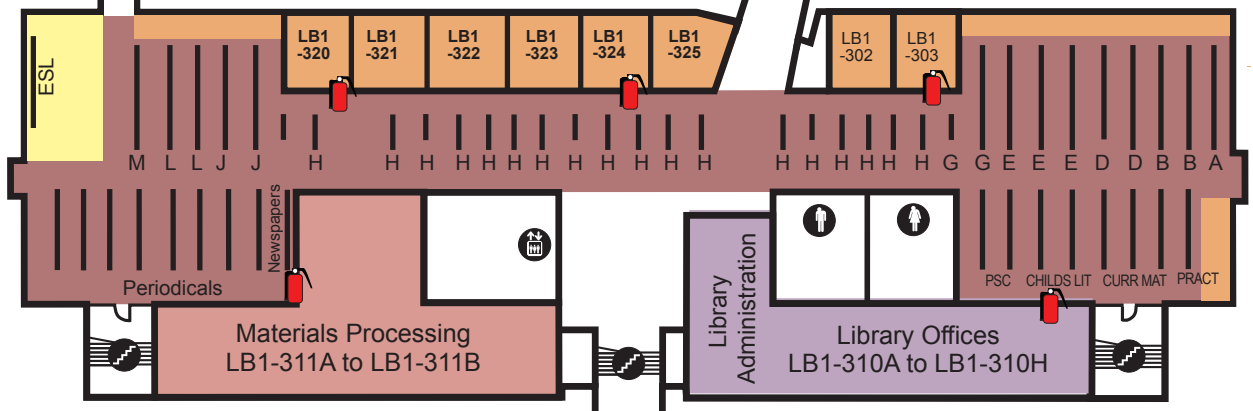

N ← CCC

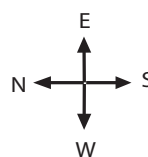

UWB → S